

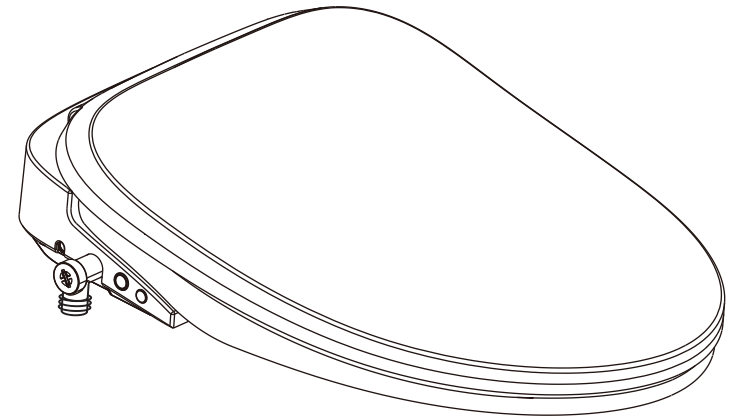

Eco-NOVA™



IMPORTANT SAFEGUARDS

When using electrical products, especially when children are present, basic safety precautions should always be followed, including the following:
READ ALL INSTRUCTIONS BEFORE USING

DANGER – To reduce the risk of electrocution:

1. Do not use while bathing.
2. Do not place or store product where it can fall or be pulled into a tub or sink.
3. Do not place in or drop into water or other liquid.
4. Do not reach for a product that has fallen into water. Unplug immediately.

WARNING – To reduce the risk of burns, electrocution, fire, or injury to persons.

1. Close supervision is necessary when this product is used by, on, or near children or invalids.
2. Use this product only for its intended use as described in this manual. Do not use attachments not recommended by the manufacturer.
3. Never operate this product if it has a damaged cord or plug, if it is not working properly, if it has been dropped or damaged, or dropped into water. Return the product to a service center for examination and repair.
4. Keep the cord away from heated surfaces.
5. Never block the air openings of the product or place it on a soft surface, such as a bed or couch, where the air openings may be blocked. Keep the air openings free of lint, hair, and the like.
6. Never use while sleeping or drowsy.
7. Never drop or insert any object into any opening or hose.
8. Do not use outdoors or operate where aerosol (spray) products are being used or where oxygen is being administered.
9. Connect this product to a properly grounded outlet only. See Grounding Instructions.
10. Do not use while bathing.

11. Risk of Electric Shock. Connect Only to a Grounding Type Receptacle Protected by a Ground-Fault Circuit-Interrupter (GFCI)

12. Risque de choc électrique. Connecter uniquement à un réceptacle du Type de mise à la terre protégé par un circuit de fautes au sol (GFCI).

13. CAUTION - Risk of electric shock, do not remove cover (or back). Refer servicing to qualified service personnel.

14. Attention - risque de choc électrique, n'enlevez pas le couvercle (ou le dos). Référer le service à un service qualifié Personnel.

SAVE THESE INSTRUCTIONS

GROUNDING INSTRUCTIONS

This product should be grounded. In the event of an electrical short circuit, grounding reduces the risk of electric shock by providing an escape wire for the electric current.

This product is equipped with a cord having a grounding wire with a grounding plug.

The plug must be plugged into an outlet that is properly installed and grounded.

DANGER – Improper use of the grounding plug can result in a risk of electric shock.

If repair or replacement of the cord or plug is necessary, do not connect the grounding wire to either flat blade terminal. The wire with insulation having an outer surface that is green with or without yellow stripes is the grounding wire. Check with a qualified electrician or serviceman if the grounding instructions are not completely understood, or if in doubt as to whether the product is properly grounded.

Contents

- Parts & Diagrams 1
- Safety Precautions 2-3
- Installation
 - Installation Requirements 4
 - Installation Tools & Parts 5
 - Unit Installation 6-7
 - Remote Control Bracket Installation 7
- Operation 8-11
- Maintenance 12
- Specifications 13
- Troubleshooting 14-15
- Warranty 16
- Care & Cleaning Tips 17
- Repair & Service 17

Parts & Diagrams

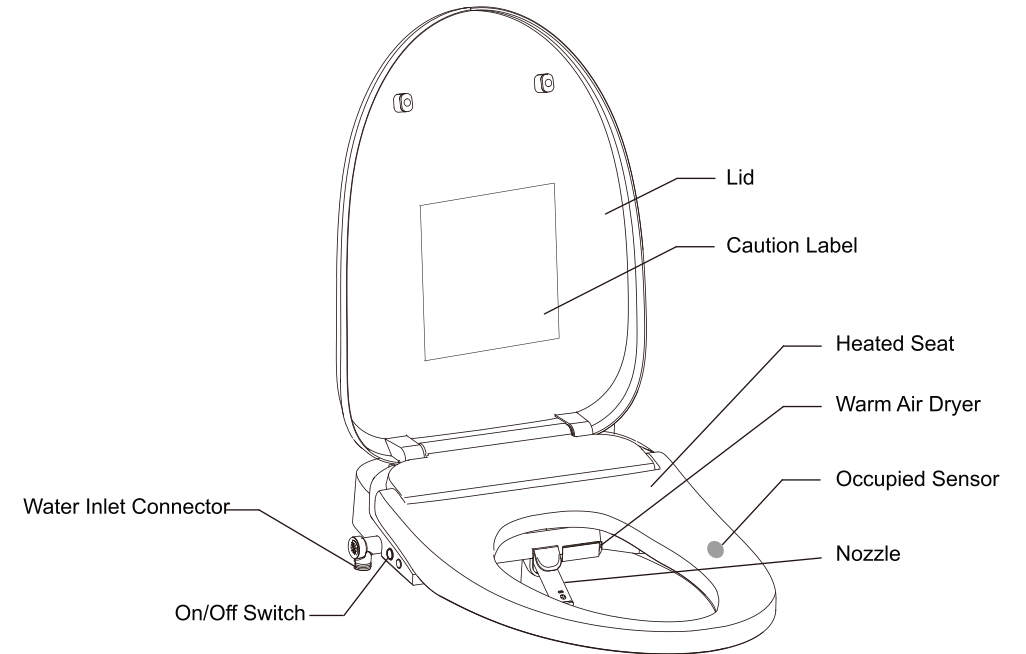

View from the right

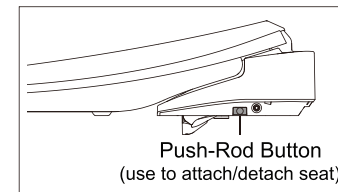

View from the left

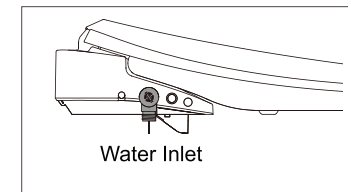

Safety Precautions



WARNING! Not following safety precautions may result in serious injury.



Grounding

This unit must be grounded before use and plugged into a power outlet.
(AC 120V, 60Hz)

*** Not doing so may cause fire or electric shock.



Prohibited

Do not use a damaged power cord, plug or loose electric outlet.

*** Doing so may cause fire or electric shock.



Wet hands prohibited

Do not plug or unplug the power plug with wet hands.

*** Doing so may cause electric shock.



Fire prohibited

Keep cigarettes and other open flames away from the unit.

*** Not doing so may cause fire, electric shock, excess heat or short circuit.



Disassembling,
remodeling prohibited

Never disassemble, repair or alter the unit.

*** Doing so may cause fire, electric shock, excess heat or short circuit.

Safety Precautions



Prohibited

Children, elderly users and individuals with physical limitations should be accompanied while operating the bidet seat.

*** Sitting on the warm seat for extended periods may cause low-temperature burns.



WARNING! May result in electric shock, fire, injury or property damage.



Prohibited

Do not strike, pull, twist, excessively bend, damage, alter or heat the power cord.



Prohibited

Do not slam or close the seat or lid forcefully.



Prohibited

Do not stand on top of the seat lid, seat or main body, as this can damage or break the unit.



Prohibited

Unplug the unit when cleaning or if not in use for extended periods of time.



Prohibited

Children should be supervised when near the bidet seat.



Prohibited

Never immerse the unit in water.

Installation Requirements

■ Power Requirements

- The power rating should be within the required range (AC 120V \pm 10%, max draw is 15A)
- The power outlet should be in a dry location close enough to be easily reached by the power cord (1.2m).
- This product must be grounded.
 - Wiring should be installed by a professionally licensed electrician.
 - To prevent malfunction, do not plug the unit in until after installation is complete.

■ Water Requirements

- The minimum dynamic water pressure required is 11.6 psi (0.8kg/square cm).
- The maximum static water pressure required is 101.5 psi (7 kg/square cm).
- Water pressure outside the minimum and maximum range will affect the performance of the unit.

■ Sizing Requirements

- Please measure your toilet to make sure that there is enough space for the bidet seat (20.43 inches long).

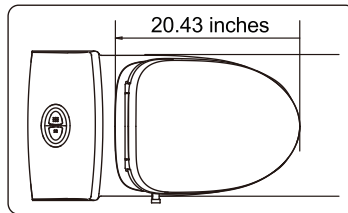

Distance between the 2 mounting holes must be between 4.5 and 7 inches.



Distance between the mounting holes and the front edge of the toilet bowl must be between 18 and 19.75 inches.

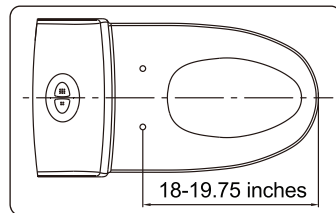

Installation Tools & Parts

Tools

Adjustable or Open-End Wrench

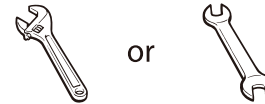

Phillips \oplus Screwdriver

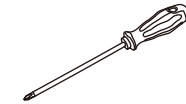

Parts

Bolts (2)



Brackets (2)

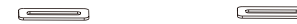

Mounting Plate

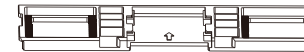

Rubber Bolts (2)



Metal Washers (2)



Template

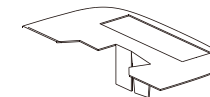

For Seat Installation

Water Supply Hose



T-Valve



For Plumbing Installation

Unit Installation

1 Remove the existing seat.

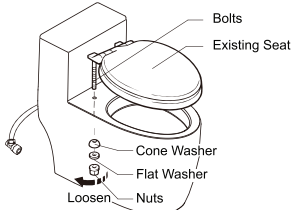

Remove the bolts on both sides of the existing toilet seat to remove the seat. Save the existing seat and bolts for later use.

2 Insert Rubber Bolts into Bolt Holes.

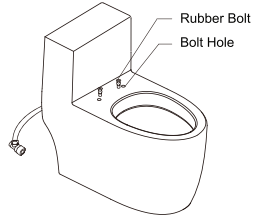

If Rubber Bolts are difficult to insert into Bolt Holes, lubricate with a drop of dish soap and twist.

3 Place and install the Mounting Plate.

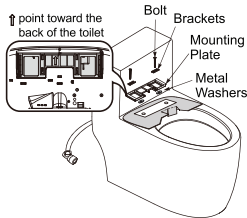

Place the template on the toilet bowl as pictured. Place the Mounting Plate in the blank space in the template. Remove the template. Insert the Bolts through the Brackets, Mounting Plate and Metal Washers as shown and tighten securely.

4 Attach or Detach the Seat.

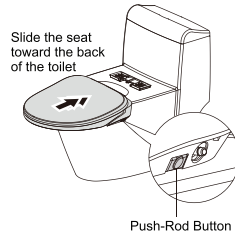

To attach: Press the Push-Rod Button and slide the seat into the mounting plate.

To detach: Press the Push-Rod Button and slide the seat off.

5 Shut off the water supply and connect the Water Supply Hose.

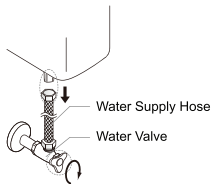

6 Connect the T-Valve to the water tank.

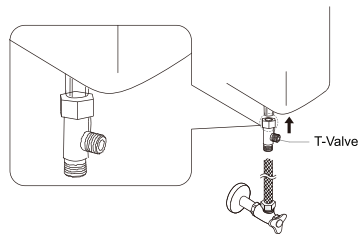

Unit Installation

7 Connect the Water Supply Hose to the T-Valve.

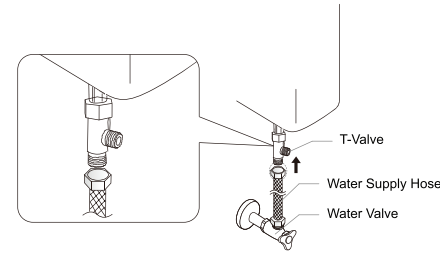

8 Connect the Hose from the T-Valve to the Bidet Inlet. Turn the Water Valve back on and check all connections for leaks.

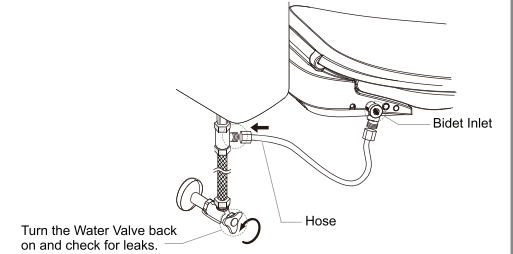

Remote Control Bracket Installation

1 Position the Remote Control Bracket.

Position the Remote Control Bracket on the wall and mark hole locations. Drill holes and insert Drywall Anchors. (Double-stick tape may be used instead of screws if desired.)

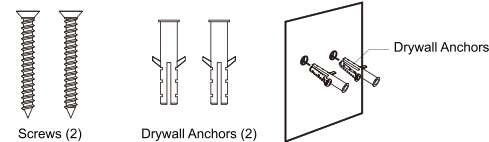

2 Install the Remote Control Bracket.

Line up the Remote Control Bracket with the drywall anchors and attach with screws (or attach the Bracket to the wall with double-stick tape). Put the remote control into the Bracket.

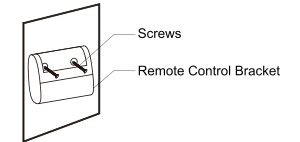

Operation

Sit on the toilet seat to activate the body sensor. The wash and warm air dryer functions will not work unless the body sensor on the seat detects that the seat is occupied.

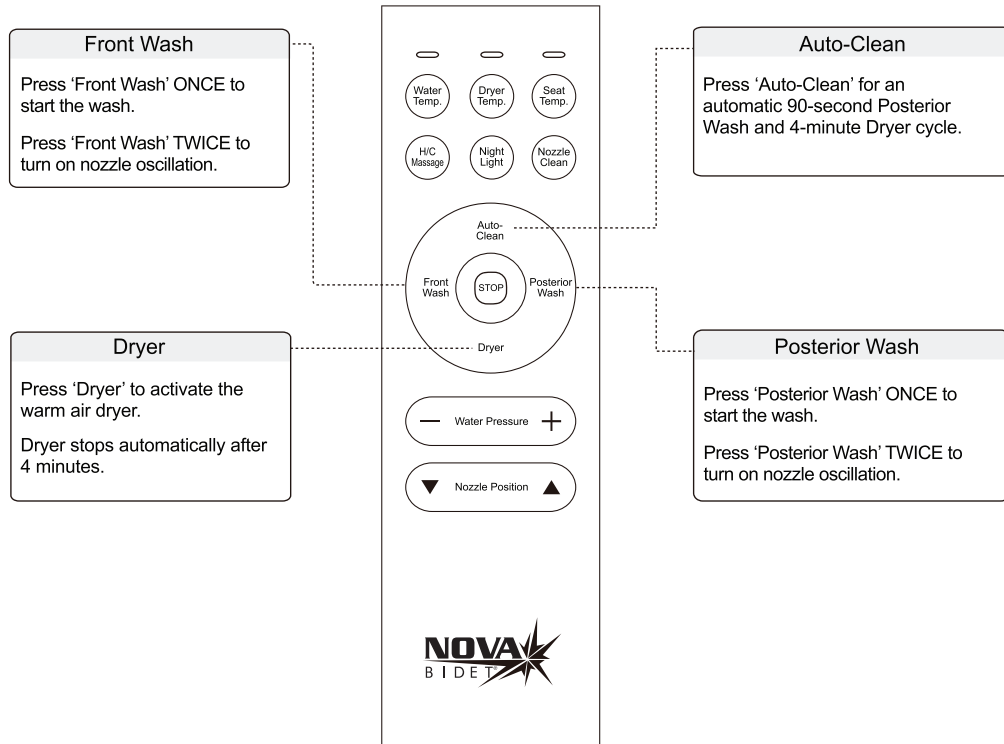

Operation

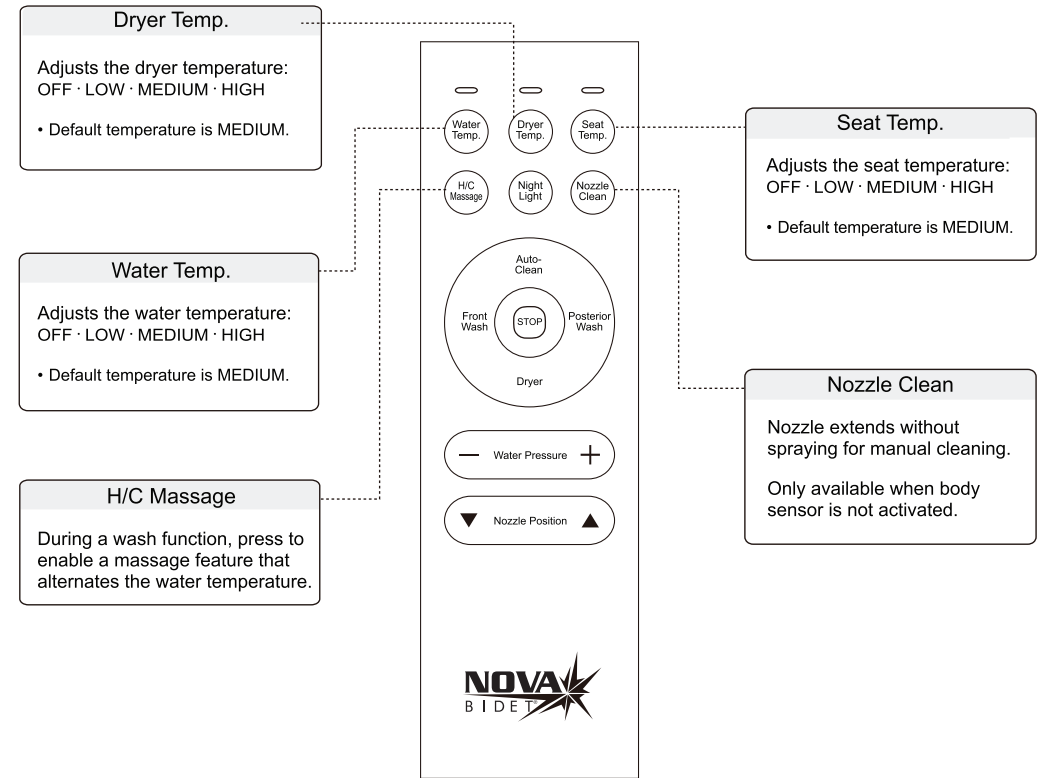

Operation

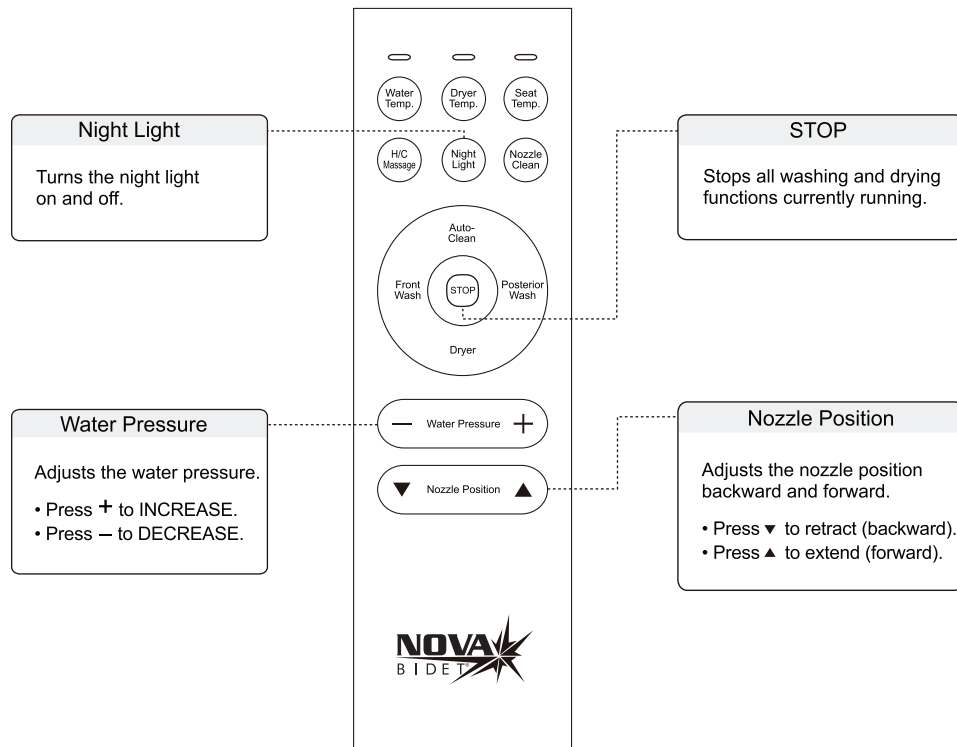

- ※ Remote feedback beeping is on by default. Long-press 'Night Light' for 3 seconds to turn beeping on or off.
- ※ Remote requires one CR2032 coin battery.

Operation

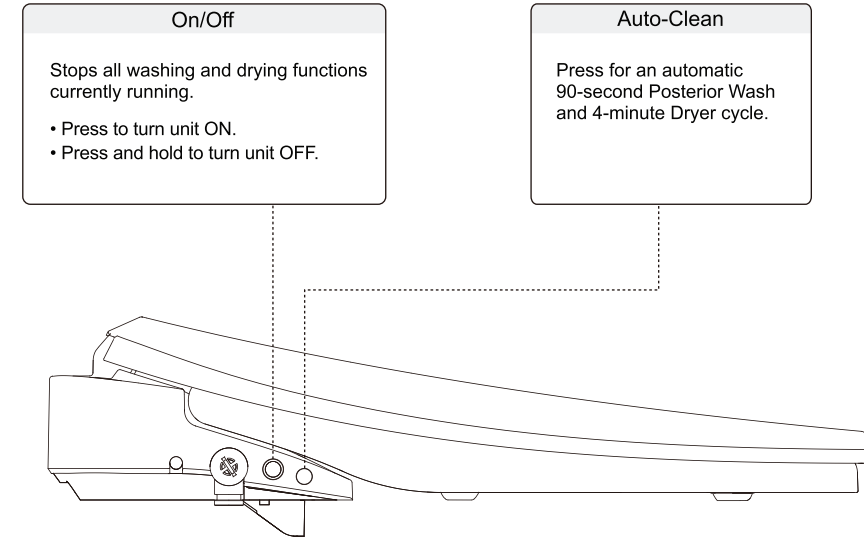

Restore Factory Settings

To restore the original settings, unplug the unit for 1 minute and then plug it in again. The water temperature, seat temperature, dryer temperature, water pressure and nozzle position will be restored to the default (MEDIUM) settings.

Remote Control Pairing

The seats are factory coded. If you need to re-pair the code:

- Unplug the unit.
- Press and hold the STOP button on the remote until the red lights flash.
- Plug the unit back in.

Maintenance

■ Daily Care & Cleaning Tips

- Do not use tinted lotions or skin care products to avoid discoloration of the seat.
- Do not use abrasive sponges or scouring agents for cleaning. We also advise against the use of solvents, spray cans containing benzene or acidic cleaners, lime scale removers and cleaning agents containing acetic acid.
- To clean under the seat, press the Push-Rod Button and detach the seat.

Cleaning Steps

1 Unplug the power cord.

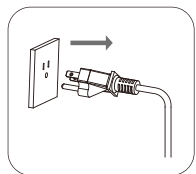

2 Clean the Unit.

Regularly wipe the seat with a dry cloth or wash with a damp cloth or sponge and mild soap. Wipe dry.



IMPORTANT! To protect the unit, use only gentle, all-natural cleaners.

3 Clean the Steel Mesh Filter.

Insert a coin and turn it counterclockwise to open the filter, then clean it with a brush.

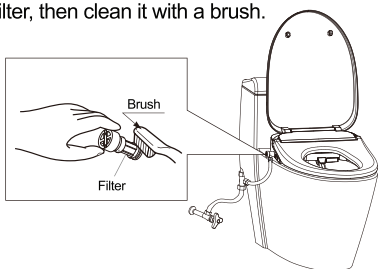

4 Clean the Nozzle.

Press the 'Nozzle Clean' button on the remote control to extend the nozzle. Clean the nozzle with a soft brush.

IMPORTANT! Do not attempt to pull the nozzle out manually. Doing so may damage the nozzle.

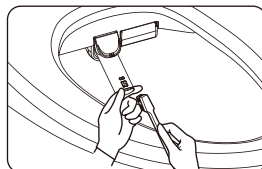

Specifications

Model Number		Eco NOVA
Rated Voltage		AC 120V, 60Hz
Rated Power		1140W
Length of Power Cord		47.2 inches
Circuit Breaker		Within 10mA 0.1 second
Wash	Posterior	0.17 gal/min
	Front	0.17 gal/min
	Heat Capacity	1140W
	Safety Feature	Temperature Switch
Dry	Air Temperature	Room temperature ~ 131°F (approximately)
	Heat Capacity	250W
	Safety Feature	Thermal Fuse, Bimetal
Heated Seat	Seat Temperature	93.2°F ~ 104°F (approximately)
	Heat Capacity	30W
	Safety Feature	Thermal Fuse
Fire Protection	Seat	5VA
	PCB Board Shell	V - 0
Water Supply	Connection	Direct connection to water supply
	Water Pressure (required)	11.6 psi ~ 101.5 psi (incoming)
Dimensions	Elongated Seat	20.43 inches x 17.72 inches x 5.24 inches

Troubleshooting

- If you experience any of the problems below, please follow the suggested solutions. If issues continue after trying these solutions, please contact your bidet seat dealer or NOVA Bidet.



Symptom	Problem	Solutions
Bidet seat is not working.	No power.	Check that the power cord is plugged in. If it is plugged in, unplug the unit, wait 1 minute and plug it in again.
	GFI or circuit breaker is blown.	Check GFI and circuit breaker.
Water does not spray.	Water supply is turned off.	Turn on the Water Supply Valve (see p. 7).
	Water hose is twisted.	Straighten the hose.
	Steel mesh filter is clogged.	Clean the steel mesh filter (see p. 12).
Water pressure is weak.	Water pressure is set to LOW.	Set the water pressure to a higher level (see p. 10).
	Steel mesh filter is clogged.	Clean the steel mesh filter (see p. 12).
Spray is off-center.	Operational failure.	Unplug the unit, wait 1 minute and plug it in again.
Water is not warm.	Water temperature is set to OFF/LOW.	Set the water temperature to a higher level (see p. 9).
Water is leaking.	Parts are loose or damaged.	Repair as needed (see pp. 6-7).

Troubleshooting

Symptom	Problem	Solutions
Wash function does not activate.	The body sensor does not detect that the seat is occupied.	Adjust sitting position so body sensor is activated.
	The body sensor is broken.	Contact your bidet seat dealer or NOVA Bidet.
Dryer is not warm.	Dryer temperature is set to OFF or LOW.	Set dryer temperature to a higher level (see p. 8).
	The dryer is broken.	Contact your bidet seat dealer or NOVA Bidet.
Dryer stops during use.	Dryer is designed to stop after 4 minutes.	Enable the dryer again.
Seat is not warm.	Seat temperature is set to OFF or LOW.	Set the seat temperature to a higher level (see p. 9).
Lid or seat closes fast.	Seat or lid damper is broken.	Contact your bidet seat dealer or NOVA Bidet.
Functions operate in-turn non-stop.	QA testing mode has been activated.	Unplug the unit, wait 1 minute and plug it in again.

Side Light

Color	Meaning
White/Blue	Indicates either UV is running or eco mode has been turned on after extended period of non use
Red	Unit is on/ready to use

Warranty

- **WARRANTY STATEMENT:** For a period of 4 years from the date of purchase, NOVA Bidet will repair or replace any part that proves to be defective in material and/or workmanship under normal installation, use and service.
- **RESIDENTIAL PRODUCTS:** We provide warranty on the Eco-NOVA Bidet to the original purchaser, installed in a residential setting. This warranty is effective for the North American 120-volt UL-approved model Eco-NOVA™.
- **MECHANICAL WARRANTY:** This warranty covers all parts to be free from manufacturing defects in materials and workmanship under normal use.
- **FINISH WARRANTY:** This warranty does not cover scratching or staining from use of chemicals or cleaning agents.
- **AUTHORIZED SELLERS:** This warranty applies to sales from Authorized Sellers only.
- **LIMITATIONS:** This warranty does not cover the cost to return the damaged product to the Authorized Service Facility, nor does it cover the cost of removal or installation of the product. It does not cover the loss of use while the unit is out of service.

This NOVA Bidet Warranty also does not cover:

- Service trips to your home.
 - Improper installation, delivery or maintenance.
 - Damage caused after delivery.
 - Failure of the product due to abuse, misuse or use for other than intended purposes.
 - Use of the product for commercial purposes.
 - Damage to the product caused by accident, fire, floods or acts of God.
 - Incidental or consequential damage caused by possible defects with this product.
- **EXCLUSION OF IMPLIED WARRANTIES:** Your sole and exclusive remedy is product repair as provided in this warranty. Any implied warranties, including the implied warranties of merchantability or fitness for a particular purpose, are limited to 4 years or the shortest period allowed by law.

Repair & Service

- **SUBMITTING A WARRANTY CLAIM**
We require Proof of Purchase (a copy of your original receipt, purchase order or invoice), the name of the Authorized Seller and the date the bidet seat was purchased. Please contact us for packing/mailling instructions.
- **OUR DISTRIBUTION & SERVICE FACILITY**
NOVA Bidet
Hygiene for Health
12877 Emerson Dr., Brighton, MI 48116
(248) 230-8461
info@novabidet.com
novabidet.com

