

**Installation Manual and
Operating Instructions**

BB-400

www.biobidet.com

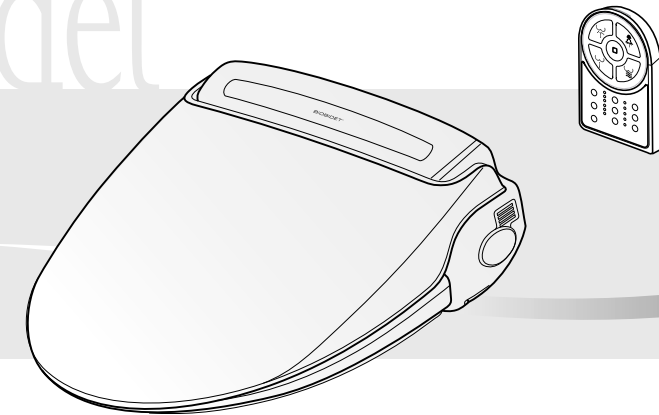

BBC Innovation Corporation

Head office:
205 Berg St
Algonquin, IL 30102
U.S.A
Tel: (847) 854-7292
Fax: (847) 854-1296

- This Product should be installed according to this manual.
- Please read this manual carefully and install properly.
- Please keep this manual for future reference.
- Please register Warranty for proper service.

bioBidet

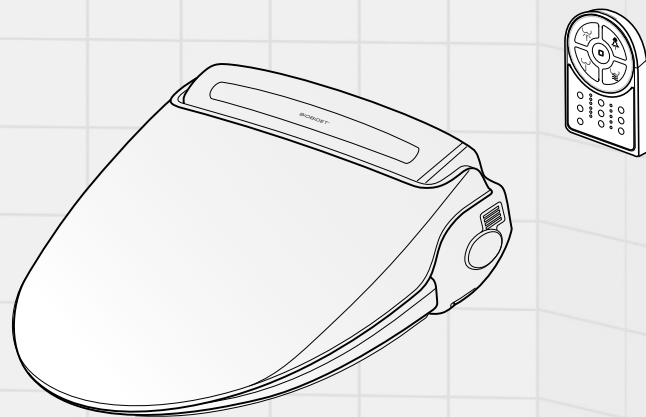

Thank you for purchasing Bio Bidet Advanced Toilet Seat
This unit was manufactured for household use.

Contents

- IMPORTANT SAFEGUARDS / GENERAL CAUTIONS 4
- CAUTIONS BEFORE INSTALLATION 6
- CARTON CONTENTS / IDENTIFICATION 8

- INSTALLATION 8
- SEPARATION OF THE UNIT FROM THE TOILET BOWL 11

- Product structure and designations 12
- OPERATION (BASIC) 14
- OPERATION (DETAILS) 15

- MAINTENANCE 18
- WATER DRAINING 19
- TROUBLE SHOOTING 20
- SPECIFICATIONS 21
- WARRANTY 22
- INFORMATION TO THE USER 23

PREPARATION

INSTALLATION

OPERATION



MAINTENANCE

1 IMPORTANT SAFEGUARDS / GENERAL CAUTIONS

● READ ALL INSTRUCTIONS BEFORE INSTALLATION AND USE

The following terms are used in this manual to indicate hazards of varying degrees of severity

DANGER	Indicates an imminently hazardous situation which, if not avoided, will result in death or serious injury.
WARNING	Indicates potentially hazardous situation which, if not avoided, could result in death or serious injury.
CAUTION	Indicates potentially hazardous situation which, if not avoided, may result in minor or moderate injury or in damage to the product or other property.

-  **DANGER** - To reduce the risk of electrocution
-  **WARNING** - To reduce the risk of burns, electrocution, fire, or injury to persons
-  **PLEASE OBSERVE THE FOLLOWING PRECAUTION BEFORE USING THIS PRODUCT**

 Do not open the product to repair or remodel.
Only qualified service personnel should service this product.
Do not use attachments not recommended by the manufacturer.



 Connect this product to cold water supply pipe carrying portable water.
Do not connect to an industrial water supply line that does not carry water of drinking quality.
This will negatively effect hygiene and performance.

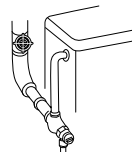

 **About Low Temperature Burns-**
A burn occurs when the skin has been exposed to high temperatures. However, a low temperature burn may occur when the skin has been in contact with an object at relatively low temperature (about 104 °F). Close supervision is necessary when this product is used by children or adults with sensitive skin.

 If using any chemical toilet bowl cleaner, be sure to wipe up any spills that splash onto Electric Bidet.
Do not use benzene or any acid chemical detergent.
Only neutral detergent permitted.

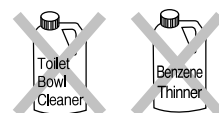

Prohibited

Do not plug in the power cord before connecting the water supply hose.

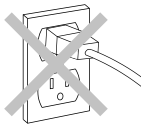

Grounding

This product must be grounded.
An approved Ground Fault Circuit Interrupt must be used.



Do not spray water

Do not splash water on this product. Please provide adequate ventilation to avoid damage to electronic components due to high level of humidity.
It is necessary to provide adequate ventilation with a fan, open door or open window when bathing.

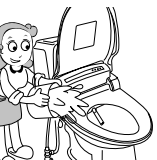

Wet hands prohibited

Do not touch the power cord with wet hands.
Do not reach for a product that has fallen into water.
Unplug immediately!

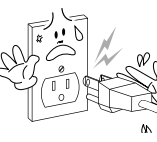

Observe at all times

This product must be connected to a standard voltage power source. Do not connect power cord if the cord is damaged or broken.
Do not plug the unit into a loose electric outlet.

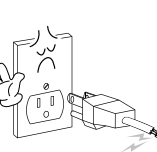

Observe at all times

Please disconnect the power cord when you clean this product or detach it from toilet bowl.
Do not supply electrical power to the unit until the plumbing work has been completed.

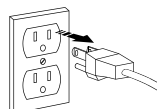

Use of fire prohibited

Keep the electrical cord away from heated surfaces to prevent a fire hazard. Also, keep any flammable materials away from this product at all times.



CAUTION



Never operate this product if it is not working properly, if it has been dropped or damaged, or dropped into water. Return the product to a service center for examination and repair.



Do not obstruct or put anything into the dry air outlet. Do not apply excessive force to the shower nozzle.



Do not stand or sit on the seat cover lid. It is not designed to support a user's body weight.



Allow the seat and lid to close automatically do not force the lid closed.



Do not strain or push the connected hose and tube connector; it may cause water leakage. Never drop or insert any object into any opening or hose. Use proper plumbing supplies if any modification is to be made.

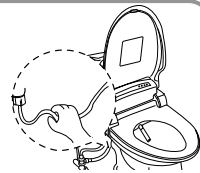

Use this product only as described in the operating instructions. Never use while sleeping or drowsy. Do not use while bathing.



Be careful so that this product does not become stained with excrement and urine.



Drain the water from unit and unplug the power if it is not going to be used for an extended period of time. Refer to page 19

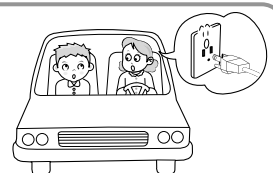

- SAVE THESE INSTRUCTIONS -

2 CAUTIONS BEFORE INSTALLATION

WIRING REQUIREMENT

THIS PRODUCT MUST BE PLUGGED into a regular voltage Grounded GFCI outlet (North America 120V ac, 60Hz / Europe 220-240V~, 50/60Hz). The rated power consumption is 660W / 600-700W. In locations where only a standard two-prong outlet is available, it is the responsibility of the user to install a grounded three-prong outlet. Using a higher voltage is dangerous and may result in a fire or other accident. This product is not responsible for damage resulting from the use of it on other than specified voltage, or operating it without proper grounding.



WARNING

This Product must be on a separate circuit. No other appliance should share the circuit with this product. Sharing a circuit could cause the branch circuit fuse to blow or the circuit breaker to trip. Continuous usage under these conditions could result in fire or property damage.

GROUND INSTRUCTIONS

- (1) This product has a three-prong grounding plug, which must be plugged into an outlet that is properly installed and grounded. In the event of an electrical short circuit, grounding reduces the risk of electric shock by providing an escape wire for the electric current. If repair or replacement of the cord or plug is necessary, do not connect the grounding wire to either flat blade terminal. The wire with insulation having an outer surface that is green with or without yellow stripes is the grounding wire. Check with a qualified electrician or serviceman if the grounding instructions are not completely understood, or if in doubt as to whether the product is properly grounded.
- (2) This product is for use on a nominal 120V circuit, and has a grounding plug that looks like the plug illustrated in sketch A in Figure 1. A temporary adapter, which looks like the adapter illustrated in sketches B and C, may be used to connect this plug to a 2-pole receptacle as shown in sketch B if a properly grounded outlet is not available. The temporary adapter should be used only until a properly grounded outlet (sketch A) can be installed by a qualified electrician. The green colored rigid ear, lug, or the like extending from the adapter must be connected to a permanent ground such as a properly grounded outlet box cover. Whenever the adapter is used, it must be held in place by the screw.

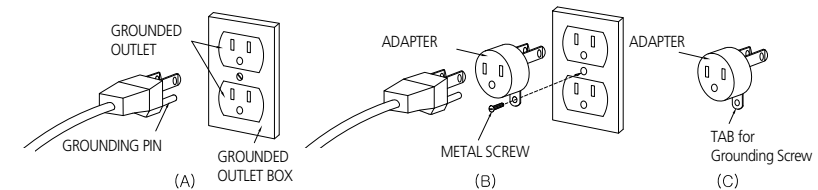

- Figure 1-

This appliance has to be earthed.



DANGER

IMPROPER GROUNDING CAN RESULT IN A RISK OF ELECTRIC SHOCK. Electric wiring has to be done in accordance with all local codes, or in the absence of local codes, with the National Electrical Codes.

The use of an extension cord is not recommended or advised. If it is necessary to use an extension cord, use only a three-prong extension cord (one to one), and a three slot built-in GFCI receptacle that will accept the plug on this product. The marked rating of the extension cord should be equal to or greater than the electrical rating of the unit (10amp). Consult a qualified electrician or service person if you are not sure whether the unit is properly grounded.

3 Installation



Caution

- This product requires 120V usage.
- Please do not plug in the electrical cord prior to installation.
- Please consult with a licensed electrician if electrical work is needed, and in case a grounded outlet is not available, grounding should be done in order to prevent short circuits or electric shock.

Check the water valve

Check the water valve in the bathroom. You may need to consider purchasing additional components. For the following case, the T-valve alone is sufficient for connection.

■ Water supply valve

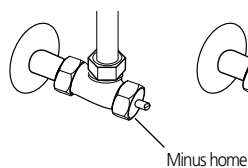

■ Inner bolt water valve

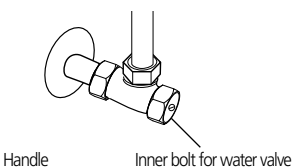

■ Professional engineering is needed for plumbing work on specialized water pipes and flush valve pipes.

- Please consult with a qualified specialist.
- Please put the unused water hose in a secure area.

Installation steps

- 1 Shut water supply by turning it to the right and disassemble the water hose.

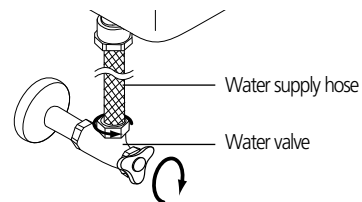

- 2 Remove existing seat and lid.

- Release the bolts on both sides of the existing toilet seat to remove the seat and lid.
- Store the removed seat, nut and water hose in a safe area in case you move or it needs to be reinstalled.

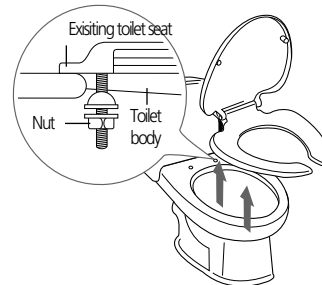

- 3 Connect the water supply hose to the T-valve. Insert the packing in the T-valve.

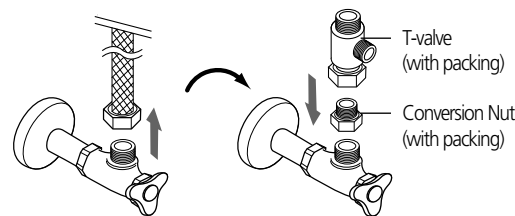

- ※ If the water supply valve opening is 1/2 inch please use a conversion nut to connect it with the T-valve.
- ※ T-valve packing must be used to prevent water from leaking.

- 4 Connect the water supply hose to the assembled T-valve.

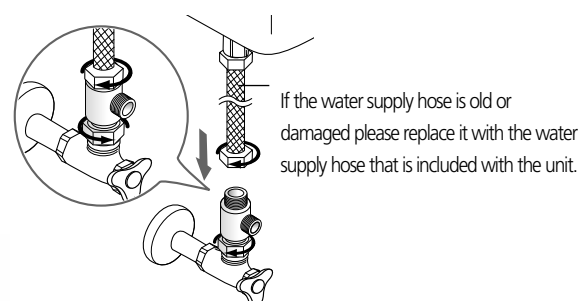

- 5 Put the bolt into the bolt case and align it with the top of the base plate. Insert bolt with bolt case onto the base plate. After this is done hold the bolts, slide it into the bottom of the unit until it snaps in place.

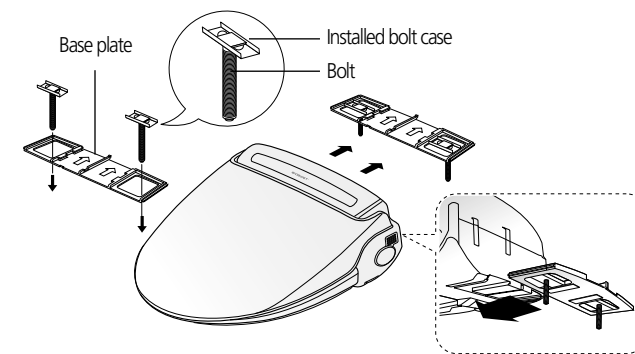

- 6 Install the main unit and insert the mounting bolts to the toilet mounting holes.

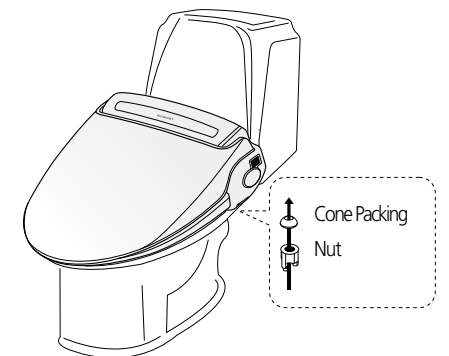

- 7 Once the base plate is attached to the unit, align the unit and toilet fixture facing front, and then insert the mounting bolts to the toilet mounting holes.

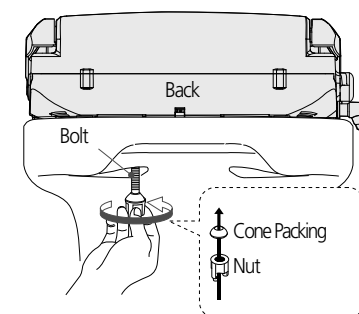

- 8 Connect the flexible tube from side of T-valve to the unit. Turn the water valve to the left to allow water to flow.

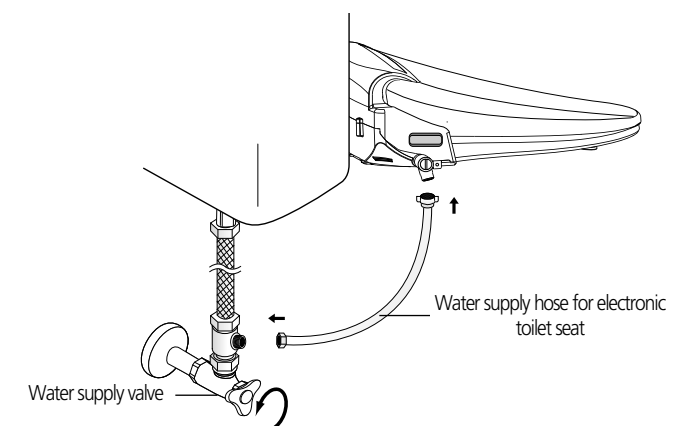

4 Initial Operation

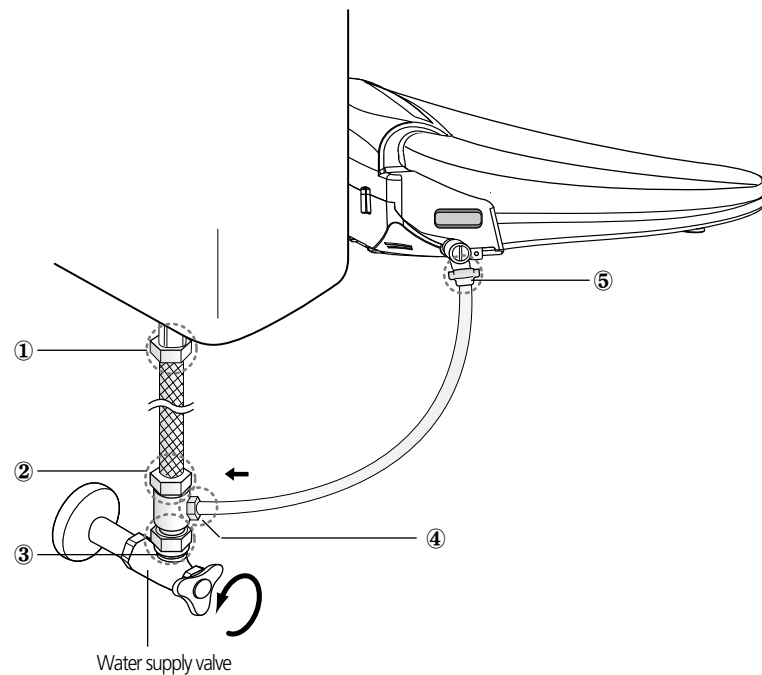

- 1 Turn the water valve to the left and see if there is any water leaking from the hose.(①~⑤)

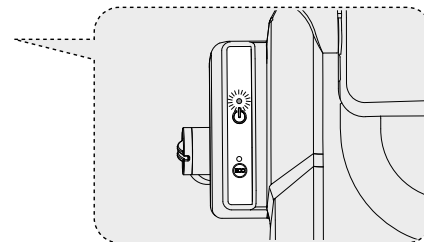

- 2 Connect the power cord to the 120V electric outlet.

- If the power light does not appear after plugging in the electric cord, press any button on the remote control.
- If you hear a 'beep' sound, then the lights will appear on the power lamp.



- 3 If you press  or  button, the water will begin to enter the heated water tank.

- If the tank is full, then a low beeping sound will occur which indicates that preparation is complete.

- 4 Function Check

- In order to check whether the functions work, you will first need to touch the seat or sit on it to activate the skin sensor.
- Please be aware that water will come out. This product can only operate when the user sits on the electronic toilet seat.

5 Separation of unit from the toilet bowl

※ Please follow the instructions below when moving or separating the unit from the toilet for cleaning purposes

- 1 Disconnect the power plug
- 2 Shut the water supply valve
- 3 Push and hold the button on the right side of the unit to completely drain the water from the water tank.
- 4 Loosen the nut on the hose that is connected to the unit, and then separate the electronic toilet seat from the toilet in the following order as illustrated.

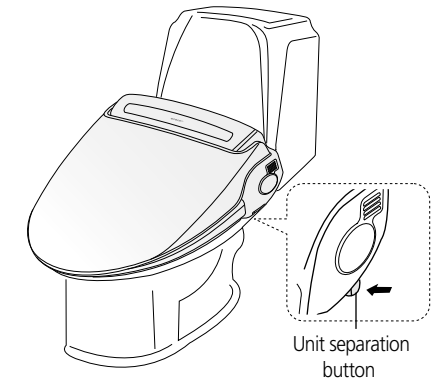

- While pushing the button (area shown as an arrow) push the electronic toilet seat slightly toward to the front and then the body unit will begin to slide out.
Next, lightly pull the unit toward the front and it will detach from the toilet.

 Do not turn the seat upside-down. This can cause damage to the unit as well as fire hazard.

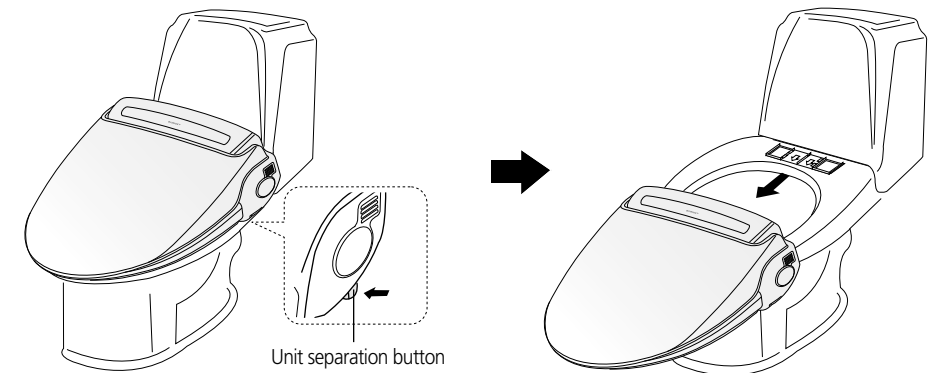

- 5 Disconnect the T-valve from the water supply. (Refer to page 8~9)
- 6 Connect the water hose to the toilet which was disassembled while installing the electronic toilet seat, and turn the water valve to the left to open it. See if there is any leaking from the water hose connection.
- 7 Re-install the toilet seat and lid that was separated when installing the electronic toilet seat.
 - As explained above, steps 1~4 are instructions for separation of the unit for basic cleaning purposes, and steps 5~7 are instructions for separation when moving, etc.

6 Product structure and designations

Main unit

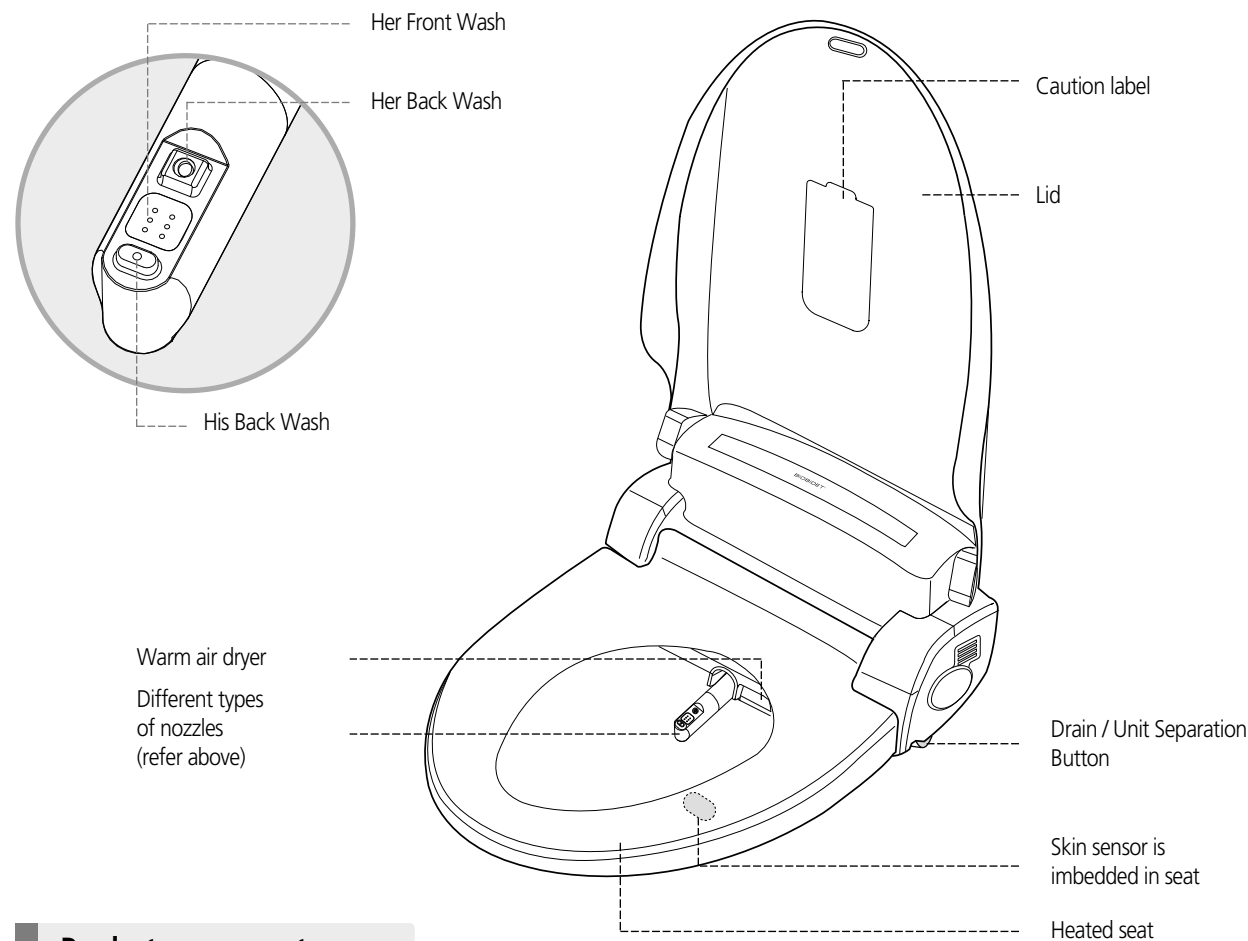

Product components

For plumbing

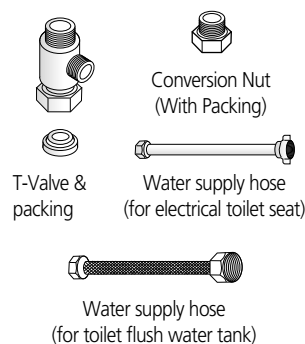

For product fixation

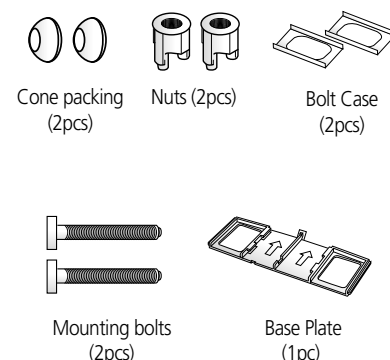

For remote control

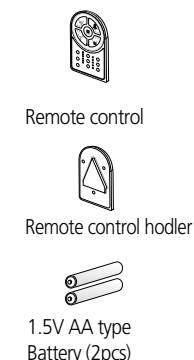

Installation instructions



Remote control

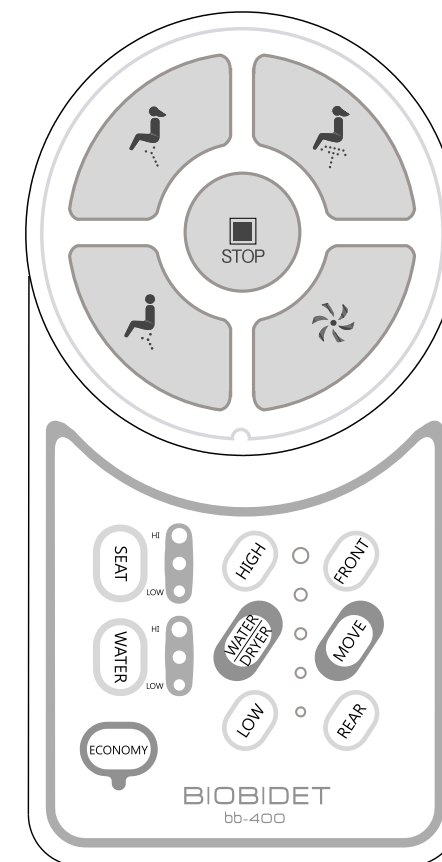

	STOP	Stop
	HER BACK	Her Back Wash
	HER FRONT	Her Front Wash
	HIS BACK	His Back Wash
	DRYER	Allows you to select your desired level of air flow before the dryer activates.
	MOVE	Move the nozzle back and forth for a wider cleanse. Press again to stop Move.
	ECONOMY	Automatically activates or deactivates the Economy mode.
	WATER DRYER	The water pressure and dryer temperature can be adjusted up to 5 levels.
	NOZZLE POSITION	The oscillating mode and nozzle position can be adjusted up to 5 levels.
	WATER	The water temperature can be adjusted up to 4 levels.
	SEAT	The seat's temperature can be adjusted up to 4 levels.
	WATER DRYER	Turn on water/dryer indicator LED.

Caution

If the remote control is not used for 10 seconds, the LED lamp will turn off automatically to protect the battery life.

- Always sit on the middle of the unit and do not sit on the side of the seat. (The basic functions will not work if the skin sensor is not active.)
- When operating, if the water temperature is low and cold water comes out after using it for a period of time, pause and wait for 3 minutes to allow the water reservoir to reheat water.
- Drying will occur quicker if toilet paper is used to wipe away excess water prior to using the dryer function.



Sitting on the heated seat or using the dryer for an extended period of time can potentially cause low degree burning. Special precautions should be taken for children, those who cannot adjust the temperature, and those who have sensitive skin.

7 Operation (Basic)



Cautions



Cautions

Please press the 'off' or 'low' button for seat temperature when the following persons use it. Special precautions should be taken for children, those who cannot adjust the temperature, and those who have sensitive skin.

Sit on the seat.

- Sit on the toilet seat so that the skin sensor can fully be activated.

Warning

- Do not press the control buttons harder than needed. This can cause damage.
- The skin sensor of the seat is only activated with bodily contact, please be sure to pull down your clothes amply and do not cover the seat with any clothing items, as it can prevent the seat from activating.

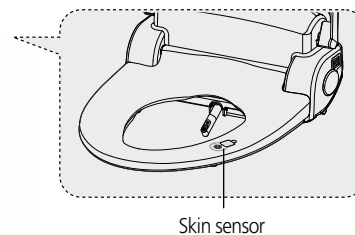



Please press or ,

- Wash is available Her Back Wash, Her Front Wash and His Back Wash.
- The selected function can be used for up to 1 minute.

Warning

- The wash functions will automatically stop after one minute. If you want to use it continuously press the button again.

Press



- The display light for the  (high),  (low) on the remote will turn on while the dryer is activated.
- The selected function can be used up to 3 minutes.
- Before using the dryer, wiping the wet area with toilet paper will let drying occur more quickly.

Press

- Her Front Wash, Her Back Wash His Back Wash wash or drying will all stop.



8 Operation (Instructions to operate each function)

Water pressure

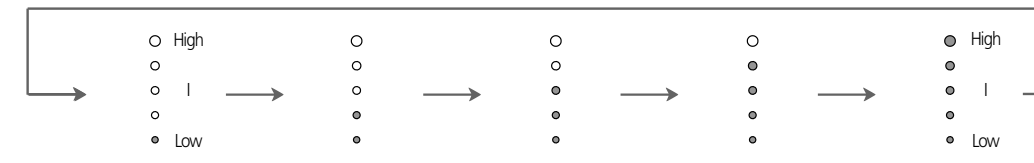

- Press  (high),  (low) for the Water/Dryer (Water pressure can be adjusted 1~5 levels.)
- It is recommended that the water filter (strainer) is cleaned periodically, as water pressure can be weakened if foreign substances cling onto the water filter (strainer). (Refer to page 18)

- LED level



- To increase water pressure press  (high) on the remote.
- To decrease water pressure press  (low) on the remote.
- As the water pressure increases the LED lights will illuminate the levels (see above illustration)



Water temperature adjustment

- When pressing  button the display light() will change to allow the adjustment of the water temperature to the desired level.
- Average maintenance time for warm water: This product can maintain the warm water level for up to 50 seconds during a 1 minute wash session.

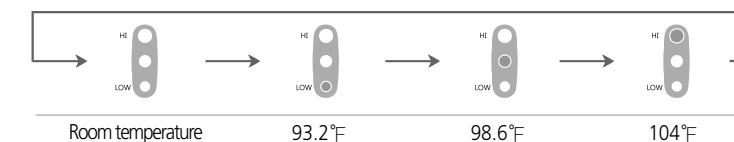
Water temperature



Seat temperature adjustment

- When pressing  button display light() will change. Temperature can be adjusted to the desired level.

Seat temperature

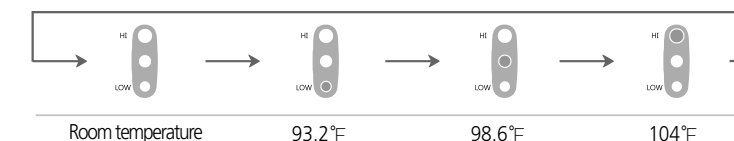

9 Operation (Instructions to operate each function)

Nozzle position adjustment

- When using the wash functions use **FRONT** (Front), **REAR** (Rear) buttons to adjust the nozzle to fit to your body.
- LED level



Warm air dryer adjustment

- The (**•••••**) display lamp for the Water pressure / Dryer will change when using the dryer function.
- Adjust the dryer temperature by pressing **HIGH** (High), **LOW** (Low) .
- The drying functions can be adjusted up to 5 levels.
- LED level



- As the warm air dryer temperature increases the LED light will illuminate (see above illustration)

Move

- When pressing the move function **MOVE** while using Her Front Wash/ Her Back Wash/ His Back Wash the nozzle will automatically move back and forth covering a wider area for washing.
- Press move button **MOVE** a second time to stop oscillation.

Automatic self cleaning nozzle

- Before and after using Her Front Wash / Her Back Wash / His Back Wash , the nozzle will automatically clean itself.

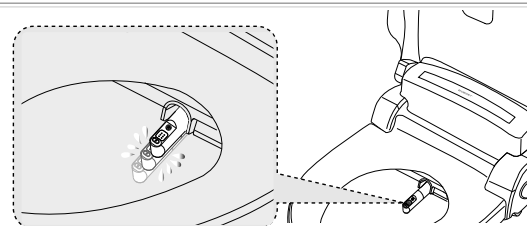

ECONOMY

- When pressing **ECONOMY** the Economy light on the electronic toilet seat will turn on.
- Economy mode automatically maintains a water and seat temperature of 89.6°F.
- If you want to turn off the Economy function, press the **ECONOMY** button again and the display light will turn off.

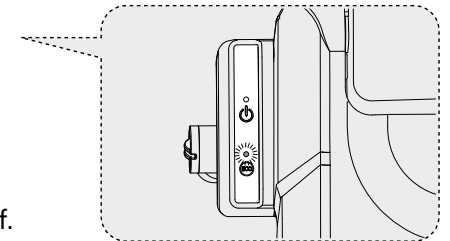

During a power outage, the water or seat heating temperature could appear to be lower than the actual temperature setting.

Other energy saving tips

In order to save energy, please abide by the following instructions:

- Keep seat cover closed when not in use to prevent heat from being lost.
- Keep temperature set to low.
- Unplug the power cord if you do not plan to use it for a long period of time.

Setting up and using the remote control

- Select a convenient spot near the toilet to attach the remote control holder.
- Make sure that the selected spot will not be exposed to water and the area where you intend to affix the holder is clean and dry.
- Remove film from the double sided tape located on the back of the remote control holder and place the holder in the selected area.
- On remote control insert the two(2) batteries (1.5V AA) ensuring that the poles on the batteries correspond to the directions on the remote control.

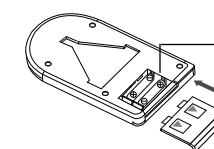

Two (2) batteries

(+, - please consider the right polarity)

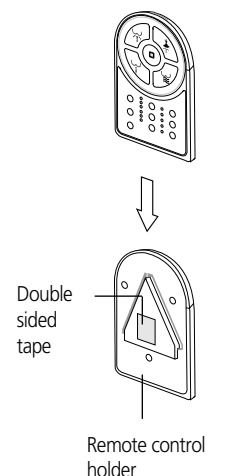

- Always purchase the correct size and grade of battery most suitable for the intended use.
- Clean the battery contacts and also those of the device prior to battery installation.
- Remove batteries from equipment which is not to be used for an extended period of time.
- Remove batteries if consumed or if product is to be left unused for a long time.

10 Maintenance

Cleaning the body unit

- Beware to not use any bathroom cleaning detergents such as benzene acid chemical detergent on the seat exterior.
- Using any type of chemical products or rough scrubbers on the electronic toilet seat surface, which is made out of plastic material can either damage or change its color.
- Do not spray water directly or use a shower hose on the main body unit.
- Can cause fire or damage to the unit.
- When cleaning, the power cord must be unplugged from the power outlet, and make sure water does not contact the cord and/or outlet.
- After cleaning, use a soft cloth to dry the unit.

 Do not use any cleaning products such as Oxy Clean.

Cleaning the water filter(strainer).

- Shut water supply by turning the water valve to the right
- Separate the strainer by using a coin to turn it to the left.
- After cleaning the filter in running water turn it back to the right to assemble it and open the water valve.

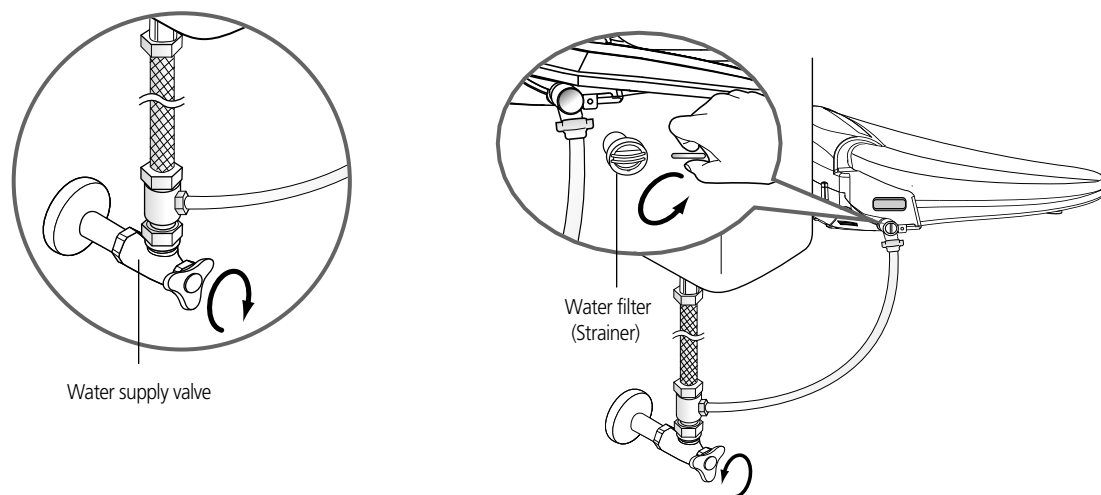

11 Draining water from tank

- 1 Disconnect the power plug.
- 2 Shut the valve by turning it to the right.
- 3 When pressing the drain button located on the side of the body unit, the water in the tank will completely drain into the toilet bowl.
 - This electronic toilet seat has considered the user's convenience in that the water can be drained easily without removing the unit from the toilet seat.

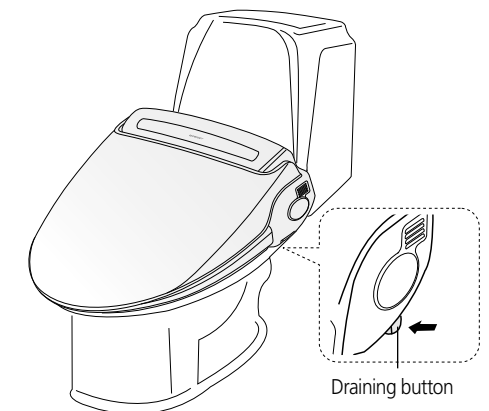
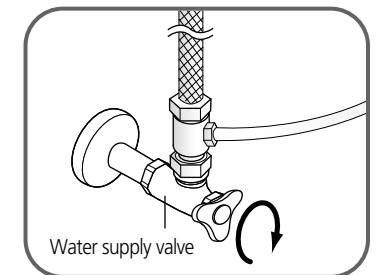

12 Maintenance for winter season

- 1 Check if the power cord is plugged in securely.
- 2 Adjust the () button to "low" to prevent water from freezing.
- 3 If the product is not used for a long period of time, please disconnect the power cord and drain the water from the internal unit.
- 4 Please do not keep this product outdoors during the winter as the cold temperature may damage the product.



13 TROUBLE SHOOTING

Trouble	Cause	Remedy
The washing water does not spray	<ol style="list-style-type: none"> 1.The water tank is not filled. 2.The shut off valve is closed. 3. Freezing inside the main unit or the water supply pipe. 	<ol style="list-style-type: none"> 1. Wait about one minute. 2.Press the desired washing button once again. 3.Turn on the shut off valve to open. 4.Heat the room (for about two hours). Operating the unit while parts are frozen will cause a malfunction.
The unit is not operating	<ol style="list-style-type: none"> 1.Disconnected the power cord. 2.The seat is not occupied. 3. The battery of remote controller is exhausted. 	<ol style="list-style-type: none"> 1.Connect the power cord. 2. Check the power supply system in your house. 3.Occupy the seat (The unit has an occupied sensor). 4.Replace the battery.
Water is leaking	<ol style="list-style-type: none"> 1.Check the water supply system 	<ol style="list-style-type: none"> 1. If water is leaking from the main unit, call the service center or the place you purchased unit.
The washing water pressure is weak	<ol style="list-style-type: none"> 1.The water pressure level is set to "LOW". 2.The strainer is clogged. 	<ol style="list-style-type: none"> 1.Set the water pressure to "HIGH". 2.Clean the strainer.
The washing water is not warm	<ol style="list-style-type: none"> 1.The water temperature is set to "LOW". 2.Continuous operation has depleted the supply of warm water. 	<ol style="list-style-type: none"> 1.Set the water temperature to "HIGH" 2. Wait about three minutes.
The seat and dryer is not warm	<ol style="list-style-type: none"> 1.The seat & dryer temperature is set to "LOW" 	<ol style="list-style-type: none"> 1. Set the seat & dryer temperature to "HIGH".

14 SPECIFICATIONS

Specification		BB-400
Power rating		120V / 60Hz / 660W
Water inlet type	Type	Direct Inlet Flow Type
	Water inlet pressure	0.4 ~ 7.5 kgf/cm ²
Wash device	Her Back Wash	Max. 700cc ± 150cc / min.
	Her Front Wash	Max. 700cc ± 150cc / min.
	His Back Wash	Max. 700cc ± 150cc / min.
	Water pressure adjustments	5 levels
	Warm water temperature control	Room Temp. ~ 93.2°F, 98.6 °F, 104 °F
Heated seat	Heater	600W
	Safety device	Thermal fuse, Thermal switch, Float switch
	Temperature control	Room Temp. ~ 93.2 °F, 98.6 °F, 104 °F
	Heater	55 W
Warm Air Dryer Device	Safety device	Thermal fuse, Bimetal
	Warm air control	Room temp ~ 113 °F , 5 levels
	Heater	250W
Inlet water temperature	37.4 °F ~ 95° F (3° C ~ 35° C)	
	Ambient temperature	
Dimensions	37.4 °F ~ 104° F (3° C ~ 40° C)	
	Elongated	Round
Weight (lbs)	W : 18.1inch (461mm) L : 20.6inch (525mm) H : 7.28inch (185mm)	W : 18.1inch (461mm) L : 19.4inch (493mm) H : 7.28inch (185mm)
	11.9 lbs (Packed : 16.5 lbs)	11.7 lbs (Packed : 16.3 lbs)

15 WARRANTY

Three Years Limited Warranty

1. 100% Coverage of all parts and labor for the entire product for the first year from original date of purchase
2. 75% Coverage of all parts and labor for the entire product for the second year from original date of purchase
3. 50% Coverage of all parts and labor for the entire product for the third year from original date of purchase

BBC Innovation warrants its products to be free from manufacturing defects under normal use and service for a period of three (3) years prorated base as above from date of purchase. This warranty is extended only to the ORIGINAL PURCHASER.

BBC Innovation's obligations under this warranty are limited to repair or replacement, at BBC Innovation's option, of products or parts found to be defective, provided that such products were properly installed and used in accordance with instructions. BBC Innovation reserves the right to make such inspections as may be necessary in order to determine the cause of the defect. BBC Innovation will not charge for labor or parts in connection with warranty repairs or replacements. BBC Innovation is not responsible for the cost of removal, return and/or reinstallation of products.

This warranty does not apply to the following items:

- Damage or loss sustained in a natural calamity such as fire, earthquake, flood, thunder electrical storm, etc.
- Damage or loss resulting from any unreasonable use, misuse, abuse, negligence, or improper maintenance of the product.
- Damage or loss resulting from removal, improper repair, or modification of the product.
- Damage or loss resulting from sediments or foreign matter contained in a water system.
- Damage or loss resulting from improper installation or from installation of a unit in a harsh and/or hazardous environment.

This warranty gives you specific legal rights. You may have other rights which vary from state to state.

To obtain warranty repair service under this warranty, you must take the product or deliver it prepaid to a BBC Innovation service facility together with a letter stating the problem, or contact a BBC Innovation distributor or products service contractor, or write directly to BBC Innovation Corporation, 205 Bert Street, Algonquin, IL 60102.

This written warranty is the only warranty made by BBC Innovation. Repair or replacement as provided under this warranty shall be the exclusive remedy available to the purchaser. BBC Innovation shall not be responsible for loss of the product or for other incidental, special or consequential damages or expenses incurred by the purchaser, or for labor or other costs due to installation or removal, or costs of repairs by others, or for any other expense not specifically stated above. Except to the extent prohibited by applicable law, any implied warranties, including that of merchantability or fitness for use, are expressly limited to the duration of this warranty. Some states do not allow limitations on how long an implied warranty lasts, or the exclusion or limitation of incidental or consequential damages, so the above limitation and exclusion may not apply to you.

Warning! BBC Innovation shall not be responsible or liable for any failure of, or damage to, this plumbing product or product component caused by either chloramines in the treatment of public water supply or in-tank bowl cleaners containing chlorine (calcium hypochlorite).

Note: The use of high concentration of chlorine or chlorine related products can seriously damage the fittings. This damage can cause leakage and serious property damage.

16 INFORMATION TO THE USER (For America)

This equipment has been tested and found to comply with the limits for a Class B digital device, pursuant to part 15 of the FCC Rules. These limits are designed to provide reasonable protection against harmful interference in a residential installation. This equipment generates, uses and can radiate radio frequency energy and, if not installed and used in accordance with the instructions, may cause harmful interference to radio communications. However, there is no guarantee that interference will not occur in a particular installation. If this equipment does cause harmful interference to radio or television reception, which can be determined by turning the equipment off and on, the user is encouraged to try to correct the interference by one more of the following measures:

- Reorient or relocate the receiving antenna.
- Increase the separation between the equipment and receiver.
- Connect the equipment into an outlet on a circuit different from that to which the receiver is connected.
- Consult the dealer or an experienced radio/TV technician for help.

WARNING

Changes or modifications not expressly approved by the manufacturer could void the user's authority to operate the equipment.

Note : The manufacturer is not responsible for any Radio or TV interference caused by unauthorized modifications to this equipment. Such modifications could void the user's authority to operate the equipment.

For Service & Technical Support, call or write to:

BBC Innovation Corporation
205 Berg St
Algonquin, IL 30102
U.S.A

Tel: 847.854.7292
Fax: 847.854.1296
Support@biobidet.com